

Name: Adam Drake

Date: 7-2007

Event: Std. Set-Up

City: State:

Track:

Track ☐ Indoor ☐ Tight ☐ Smooth ☐ Hard Packed ☐ Blue Groove ☐ Wet ☐ Low Bite ☐ High Bite
Conditions ☒ Outdoor ☐ Open ☐ Rough ☐ Loose/Loamy ☐ Dry ☐ Dusty ☐ Med Bite ☐ Other _____

Front Suspension

Toe: 2 degrees out
Ride Height: 36mm
Camber: -1
Caster: Stock 20 degrees
Sway Bar: 2.3mm
Piston/Oil: 54 / 42.5wt
Spring: Black
Limiter/Droop: _____
Overall Shock Length: 95mm
Steering Ackerman: Stock
Bump Steer: Down
Camber Link: #2
Shock Location: #3 / middle
Front Diff Fluid: 7000 Team Losi
Receiver Battery Type: Trinity

Center Diff Fluid: 10,000 Team Losi

Ackerman Long Short
Bump Steer Up Down

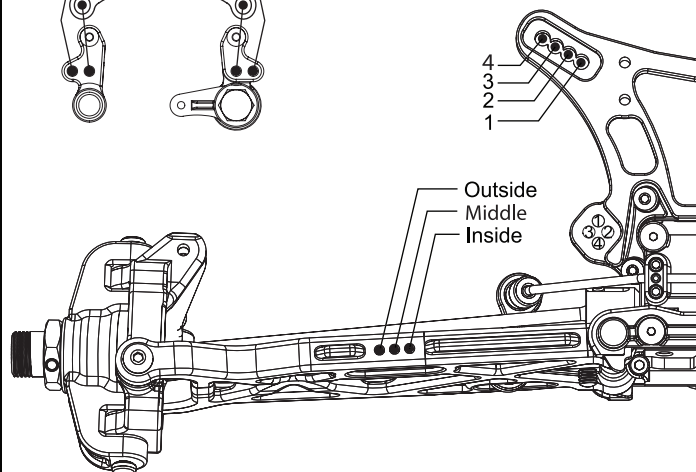

Notes: _____

Rear Suspension

Toe: 2 degrees
Anti-Squat: 3 degrees
Ride Height: 38mm
Camber: -2 degrees
Rear Hub Spacing: Forward
Sway Bar: 2.5mm
Piston/Oil: 56 / 27.5wt
Spring: Grey
Limiter/Droop: _____
Overall Shock Length: 110mm
Camber Link: #4 / A
Shock Location: #3 / middle
Rear Diff Fluid: 3000 Team Losi

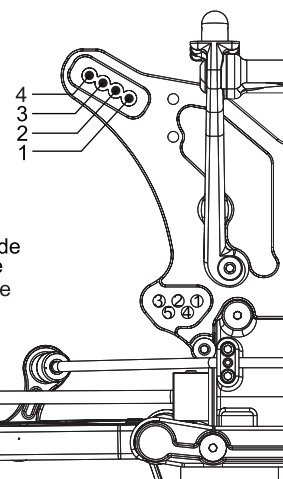

Notes: _____

Engine

Engine: Trinity Platinum Drake .21 Fuel: Trinity Platinum 30%
Glow Plug: Trinity Drake Hot Head Clearance: .023
Pipe/Header: Trinity Drake 40023 Gearing: 13/48

Clutch

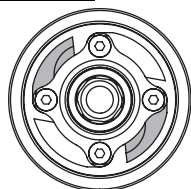

Clutch Shoes and Springs Info
4 Blue Alum with 4 silver springs

Tires

Type	Compound	Insert
Front: Team Losi XTT	Blue	Team Losi
Rear: Team Losi XTT	Blue	Team Losi

Notes: _____
